

+NOTICE!!

These documents have been scanned!

Do not place un-scanned documents beneath this notice!

Do not remove this notice from this file!

GPO Jacket No. 560-102
Print Order 61540
Rise Business Services, LLC
Job=AZ15 9/11/2019



Box Number= AZ15232



Claim Begin-End: AMC454999-AMC455004

1 Initial Receipt



AZ15232-15

AMC450067-AMC455351

United States Department of the Interior
Bureau of Land Management
 DIV OF LANDS, MINRLS & ENERGY
 ONE N CENTRAL AVE
 PHOENIX, AZ 85004 -4427
 Phone: 602-417-9200

Receipt	
No:	4460752

Transaction #: 4580542	
Date of Transaction: 05/22/2019	
CUSTOMER:	
SHARON HINTON 1311 S 1ST AVE SAFFORD, AZ 85546-2131 US	

LINE #	QTY	DESCRIPTION	REMARKS	UNIT PRICE	TOTAL
1	6.00	LOCATABLE MINERALS / MINING CLAIMS-NEW, UNADJUD, ONE OR MORE AUTH NOS / NEW MINING CLAIM PROCESSING FEE CASES: AMC454999/\$20.00, AMC455000/\$20.00, AMC455001/\$20.00, AMC455002/\$20.00, AMC455003/\$20.00, AMC455004/\$20.00		- n/a -	120.00
2	6.00	LOCATABLE MINERALS / MINING CLAIMS-NEW, UNADJUD, ONE OR MORE AUTH NOS / NEW MINING CLAIMS LOCATION FEE CASES: AMC454999/\$37.00, AMC455000/\$37.00, AMC455001/\$37.00, AMC455002/\$37.00, AMC455003/\$37.00, AMC455004/\$37.00		- n/a -	222.00
3	6.00	LOCATABLE MINERALS / MINING CLAIMS-NEW, UNADJUD, ONE OR MORE AUTH NOS / NEW MINING CLAIMS MAINTENANCE FEE CASES: AMC454999/\$155.00, AMC455000/\$155.00, AMC455001/\$155.00, AMC455002/\$155.00, AMC455003/\$155.00, AMC455004/\$155.00		- n/a -	930.00
TOTAL:					\$1,272.00

PAYMENT INFORMATION			
1	AMOUNT:	212.00	POSTMARKED: N/A
	TYPE:	CHECK	RECEIVED: 05/20/2019
	CHECK NO:	2092	
	NAME:		

		HINTON, SHARON 2106 N TUCKER AVE APT 2 FARMINGTON NM 87401 US	
2	AMOUNT:	212.00	POSTMARKED: N/A
	TYPE:	CHECK	RECEIVED: 05/20/2019
	CHECK NO:	2093	
	NAME:	HINTON, SHARON 2106 N TUCKER AVE APT 2 FARMINGTON NM 87401 US	
3	AMOUNT:	212.00	POSTMARKED: N/A
	TYPE:	CHECK	RECEIVED: 05/20/2019
	CHECK NO:	2094	
	NAME:	HINTON, SHARON 2106 N TUCKER AVE APT 2 FARMINGTON NM 87401 US	
4	AMOUNT:	212.00	POSTMARKED: N/A
	TYPE:	CHECK	RECEIVED: 05/20/2019
	CHECK NO:	2095	
	NAME:	HINTON, SHARON 2106 N TUCKER AVE APT 2 FARMINGTON NM 87401 US	
5	AMOUNT:	212.00	POSTMARKED: N/A
	TYPE:	CHECK	RECEIVED: 05/20/2019
	CHECK NO:	2096	
	NAME:	HINTON, SHARON 2106 N TUCKER AVE APT 2 FARMINGTON NM 87401 US	
6	AMOUNT:	212.00	POSTMARKED: N/A
	TYPE:	CHECK	RECEIVED: 05/20/2019
	CHECK NO:	2097	
	NAME:	HINTON, SHARON 2106 N TUCKER AVE APT 2 FARMINGTON NM 87401 US	

REMARKS

This receipt was generated by the automated BLM Collections and Billing System and is a paper representation of a portion of the official electronic record contained therein.

NOTICE!!

These documents have been scanned!

Do not place un-scanned documents beneath this notice!

Do not remove this notice from this file!

GPO Jacket No. 560-102
Print Order 61540
Rise Business Services, LLC
Job=AZ15 9/11/2019



Box Number= AZ15232



Claim Begin-End: AMC454999-AMC455004

2 Correspondence



AZ15232-15

AMC450067-AMC455351

**NO
DOCUMENTS
FOUND**

NO DOCUMENTS FOUND
NO DOCUMENTS FOUND

NOTICE!!

These documents have been scanned!

Do not place un-scanned documents beneath this notice!

Do not remove this notice from this file!

GPO Jacket No. 560-102
Print Order 61540
Rise Business Services, LLC
Job=AZ15 9/11/2019



Box Number= AZ15232



Claim Begin-End: AMC454999-AMC455004

3 Transfers



AZ15232-15

AMC450067-AMC455351

**NO
DOCUMENTS
FOUND**

NO DOCUMENTS FOUND
NO DOCUMENTS FOUND

NOTICE!!

These documents have been scanned!

Do not place un-scanned documents beneath this notice!

Do not remove this notice from this file!

GPO Jacket No. 560-102
Print Order 61540
Rise Business Services, LLC
Job=AZ15 9/11/2019



Box Number= AZ15232



Claim Begin-End: AMC454999-AMC455004

4 Annual Filings



AZ15232-15

AMC450067-AMC455351

UNITED STATES
DEPARTMENT OF THE INTERIOR
BUREAU OF LAND MANAGEMENT

252
C/MC

454999

MAINTENANCE FEE WAIVER CERTIFICATION

FORM APPROVED
OMB NO. 1004-0114
Expires: January 31, 2020

SEE INSTRUCTIONS ON PAGE 2

1. This small miner waiver is filed for the assessment year beginning on September 1, 2019 and ending on September 1, 2020
2. The undersigned and all related parties owned ten or fewer mining claims, mill, or tunnel sites located and maintained on Federal lands in the United States of America on September 1, 2019
3. The undersigned have performed the assessment work required by law for each mining claim listed prior to filing this waiver and understand that by filing this form, the undersigned must file an affidavit of assessment work with the Bureau of Land Management (BLM) by the December 30th following the filing of this waiver.
4. The undersigned understand that if the assessment work obligation has not yet come due under 30 U.S.C. 28 (for those claims in their first assessment year only), a notice of intent to hold reciting this condition must be recorded by the December 30th following the filing of this waiver.
5. The undersigned understand that mill and tunnel sites may also be listed on this waiver and be waived from payment of the maintenance fee, and that a notice of intent to hold for these sites is required to be filed with the BLM by the December 30th following the filing of this waiver.
6. The undersigned understand and acknowledge that pursuant to 43 U.S.C. 1212 and 18 U.S.C. 1001, the filing or recording of a false, fictitious, or fraudulent document with the BLM may result in a fine of up to \$250,000, a prison term not to exceed five years, or both.
7. The mining claims, mill or tunnel sites for which this waiver from payment of the maintenance fees is requested are:

CLAIM OR SITE NAME	BLM RECORDATION SERIAL NUMBER
1. Cobre Grande #1	AMC 454999
2. Cobre Grande #2	AMC 455000
3. Cobre Grande #3	AMC 455001
4. Cobre Grande #4	AMC 455002
5. Cobre Grande #5	AMC 455003
6. Cobre Grande #6	AMC 455004
7.	
8.	
9.	
10.	

RECEIVED
BLM AZ STATE OFFICE
PHOENIX, ARIZONA
AUG 14 P 3:23

The owner(s) (claimants) of the above mining claims and sites are:

6 Sharon J. Hinton ✓
 (Owner's Name - Please Print)
 1311 S 1st Ave
 (Owner's Mailing Address)

Sharon J. Hinton
 (Owner's Signature)
 Safford ARIZ 85546
 (City) (State) (Zip Code)

(Owner's Name - Please Print)
 Sheena L Leon
 (Owner's Mailing Address)

(Owner's Signature)
 (City) (State) (Zip Code)

6 Sheena Leon ✓
 (Owner's Name - Please Print)
 1311 S. 1st Ave
 (Owner's Mailing Address)

Sheena Leon
 (Owner's Signature)
 Safford ARIZ 85546
 (City) (State) (Zip Code)

ENTERED SEP 19 2019
PB

(Owner's Name - Please Print)
 (Owner's Mailing Address)

(Owner's Signature)
 (City) (State) (Zip Code)

NW ✓
(Continued on page 2)

4534488

(Owner's Name - Please Print)	(Owner's Signature)
(Owner's Mailing Address)	(City) (State) (Zip Code)
(Owner's Name - Please Print)	(Owner's Signature)
(Owner's Mailing Address)	(City) (State) (Zip Code)
(Owner's Name - Please Print)	(Owner's Signature)
(Owner's Mailing Address)	(City) (State) (Zip Code)
(Owner's Name - Please Print)	(Owner's Signature)
(Owner's Mailing Address)	(City) (State) (Zip Code)

18 U.S.C. 1001 and 43 U.S.C. 1212 make it a crime for any person knowingly and willfully to make to any department or agency of the United States any false, fictitious or fraudulent statements or representations as to any matter within its jurisdiction.

INSTRUCTIONS

1. This certification is made under the provisions of 43 U.S.C. § 1744 and 30 U.S.C. §28-28k and the regulations thereunder (43 CFR Part 3830).
2. The claimant(s) must fill in the dates in paragraph 1 for the beginning and ending of the assessment year for which this waiver is sought.
3. The claimant(s) must fill in the date in paragraph 2 for the beginning of the assessment year for which this waiver is sought.
4. All claim and site names and BLM serial numbers must be listed for the mining claims, mill sites, and tunnel sites for which the waiver is sought.
5. All owners of the mining claims, mill sites, and tunnel sites and their addresses must be given.
6. This waiver form must be signed by all the claimants or their designated agent, in original form. If an agent is designated, a notarized designation of agent, signed by all of the claimants with proper address given, must be submitted with this waiver.
7. This form must be filed no later than September 1st for the upcoming assessment year in the BLM State Office where the mining claims or sites are recorded, or the waiver cannot be granted by the BLM. (Example: To obtain a waiver for the assessment year 2012, which begins on September 1, 2011, you must qualify for and file for a waiver no later than September 1, 2011, in the proper BLM State Office.)
8. For all mining claims which require assessment work, you must record an affidavit of labor on or before the December 30th immediately following the filing of this waiver. For all other mining claims or sites waived, you must record a notice of intent to hold on or before the December 30th immediately following the filing of this waiver.
9. Mill and tunnel sites may also be listed on this waiver and be waived from payment of the maintenance fee. A notice of intent to hold for these sites is required to be filed by the December 30th following the filing of this waiver.

FOR OFFICIAL USE ONLY

NOTICE!!

These documents have been scanned!

Do not place un-scanned documents beneath this notice!

Do not remove this notice from this file!

GPO Jacket No. 560-102
Print Order 61540
Rise Business Services, LLC
Job=AZ15 9/11/2019



Box Number= AZ15232



Claim Begin-End: AMC454999-AMC455004

5 Miscellaneous



AZ15232-15

AMC450067-AMC455351

**NO
DOCUMENTS
FOUND**

NO DOCUMENTS FOUND
NO DOCUMENTS FOUND

NOTICE!!

These documents have been scanned!

Do not place un-scanned documents beneath this notice!

Do not remove this notice from this file!

GPO Jacket No. 560-102
Print Order 61540
Rise Business Services, LLC
Job=AZ15 9/11/2019



Box Number= AZ15232



Claim Begin-End: AMC454999-AMC455004

6 Location Notices-Amendments and Supporting Documents



AZ15232-15

AMC450067-AMC455351

MINING CLAIM STATUS REPORT

Data Entered: 5/28/19

MTP Checked By: _____
GEO Checked By: _____

LEAD SERIAL NUMBER: AMC 454999 thru AMC 455004

NUMBER OF CLAIMS & TYPE:

6 LODE
____ PLACER
____ ASSOCIATION PLACER
____ MILL SITE
____ TUNNEL SITE

CHARGES:

Processing Fee @ \$20 = \$ 120
Location Fee @ \$37 = \$ 222
Maintenance Fee @ \$155 = \$ 930
Add'l Maint Fee for Assoc Placer = \$ _____
SUBTOTAL \$ _____

TOTAL ACREAGE: _____ Per Claim
(Placer Only)

Other Fees \$ _____
Other Fees \$ _____

NUMBER OF LOCATORS: _____

TOTAL \$ 1,272

DOCUMENTS RECEIVED VIA: Over-the-Counter [] Mail [] **TIMELY FILED:** Yes [] No []

LEGAL DESCRIPTION: T 55 R 20E SEC 22, 27, 28
T _____ R _____ SEC _____
T _____ R _____ SEC _____
T _____ R _____ SEC _____
T _____ R _____ SEC _____

BLM [] FOREST SERVICE [] _____ SUBJ TO PL 359: Yes [] No []
WILDERNESS AREA [] _____

SPLIT ESTATE: N/A [] SX [] PX [] OTHER [] _____
SRHA [] Was proper Notice filed if located on SHRA Land? Yes [] No []

RECONVEYED MINERALS ON BLM LAND REQUIRE OPENING ORDER FROM 1944 TO 1993:
Open to Entry On _____ N/A []

COMMENTS/STATUS: VOID [] PARTIALLY VOID [] PVT MINERALS [] WITHDRAWN LANDS []
OTHER [] _____

[] Claimant acknowledges that portions of the following claim(s) site(s) may be void or voidable.

Printed Name of Claimant _____ Signature of Claimant _____

*****FINAL ADJUDICATION*****

DATE _____ INITIALS _____

AMC 454999

LOCATION NOTICE FOR LODE MINING CLAIM

Amendment BLM Serial # _____

NOTICE IS HEREBY GIVEN that the Gobre Grande #1
_____ lode mining claim has been located
by Sharon J. Hinton & Sheena Leon whose current mailing
address is 1311 S. 1st Ave
Safford, ARIZ 85546

RECEIVED
BLM AZ STATE OFFICE
2019 MAY 20 P 1:19
PHOENIX, ARIZONA
BLM
Date
Stamp

The general course of this claim is West to East and it is situated in ARAVAPO Graham
County, Arizona. This claim is 1500 feet in length and 600 feet in width.

_____ Total Claim Acreage. This claim runs from the location monument on which this location notice
is posted on the centerline of the claim approximately 1500 feet in a EASTLY direction to the SE
end line and 600 feet in a North East direction to the NE end line. This claim is marked by six
monuments, one at each corner and one at the center of each end line of the claim.

The location monument on which this notice is posted is situated within Section 22, Township 5
S, Range 20 E, Gila Salt River Base and Meridian, Arizona and this claim encompasses portions
of the following quarter section(s), section(s), Township(s) and Range(s) Quarter Section SW,
Section 22, Township 5S Range 20E

Gila Salt River Base and Meridian, Arizona.

The locality of this claim with reference to some natural object or permanent monument and additional information
(if any) concerning its locality are as follows: USGS Brass Cap

_____ The above information is shown on the attached map.

DATED AND POSTED on the ground this 13 day of May, 2019.

LOCATOR(s) AGENT

Print Name(s) Sharon J. Hinton Sheena Leon
Signature(s) Sharon J. Hinton Sheena Leon

Form MCF100
Revised July 2014

AMC454999

MINING CLAIM MAP

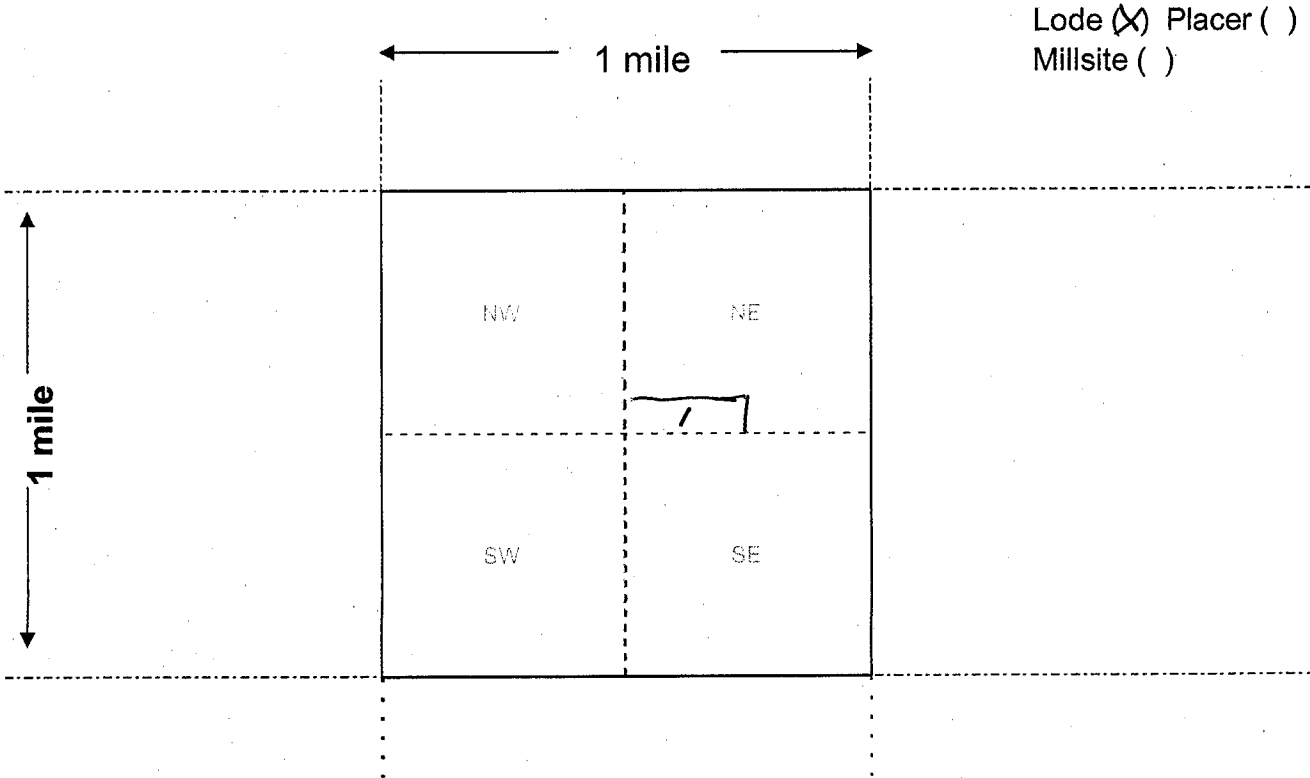

Scale: 1" = 2000 feet



1. The above map depicts the Cobre Grande #1 mining claim, which is located in Section (s) 22, Township 5 S, Range 20 E, Gila and Salt River Base and Meridian,

ARIZONA - Graham County, Arizona. Total claim acreage is _____

2. The type of corner and location monuments used are as follows: Stone

3. The bearings and distances in degrees and feet between claim corners and to a public land survey monument are as depicted on the map.

4. If the claim is a placer or millsite claim with exterior limits conforming to legal subdivisions of the public survey, provide a legal description of the claim _____

Form MCF100a
Revised July 2014

LOCATION NOTICE FOR LODE MINING CLAIM

Amendment BLM Serial # _____

NOTICE IS HEREBY GIVEN that the Cobre Grande #2
_____ lode mining claim has been located
by Sharon J. Hinton + Sheena L. Leon whose current mailing
address is 1311 S. 1st Ave
Safford, ARIZ 85546

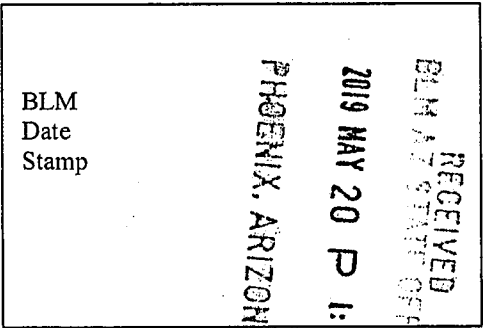

The general course of this claim is West to East and it is situated in Aravaipa Graham
County, Arizona. This claim is 1500 feet in length and 600 feet in width.

_____ Total Claim Acreage. This claim runs from the location monument on which this location notice
is posted on the centerline of the claim approximately 1500 feet in a Easterly direction to the NE
end line and 600 feet in a Southerly direction to the westerly end line. This claim is marked by six
monuments, one at each corner and one at the center of each end line of the claim.

The location monument on which this notice is posted is situated within Section 27, Township 5S
_____, Range 20 E, Gila Salt River Base and Meridian, Arizona and this claim encompasses portions
of the following quarter section(s), section(s), Township(s) and Range(s) Quarter Section NW,
Section 27, Township 5S, 20E Range
Gila Salt River Base and Meridian, Arizona.

The locality of this claim with reference to some natural object or permanent monument and additional information
(if any) concerning its locality are as follows: USGS Brass Cap section 21/22/27/28

_____ The above information is shown on the attached map.

DATED AND POSTED on the ground this 13 day of May, 2019.

LOCATOR(s) AGENT

Print Name(s) Sharon J. Hinton Sheena L. Leon
Signature(s) Sharon J. Hinton Sheena Leon

Form MCF100
Revised July 2014

AMC455000

MINING CLAIM MAP

Lode () Placer ()
Millsite ()

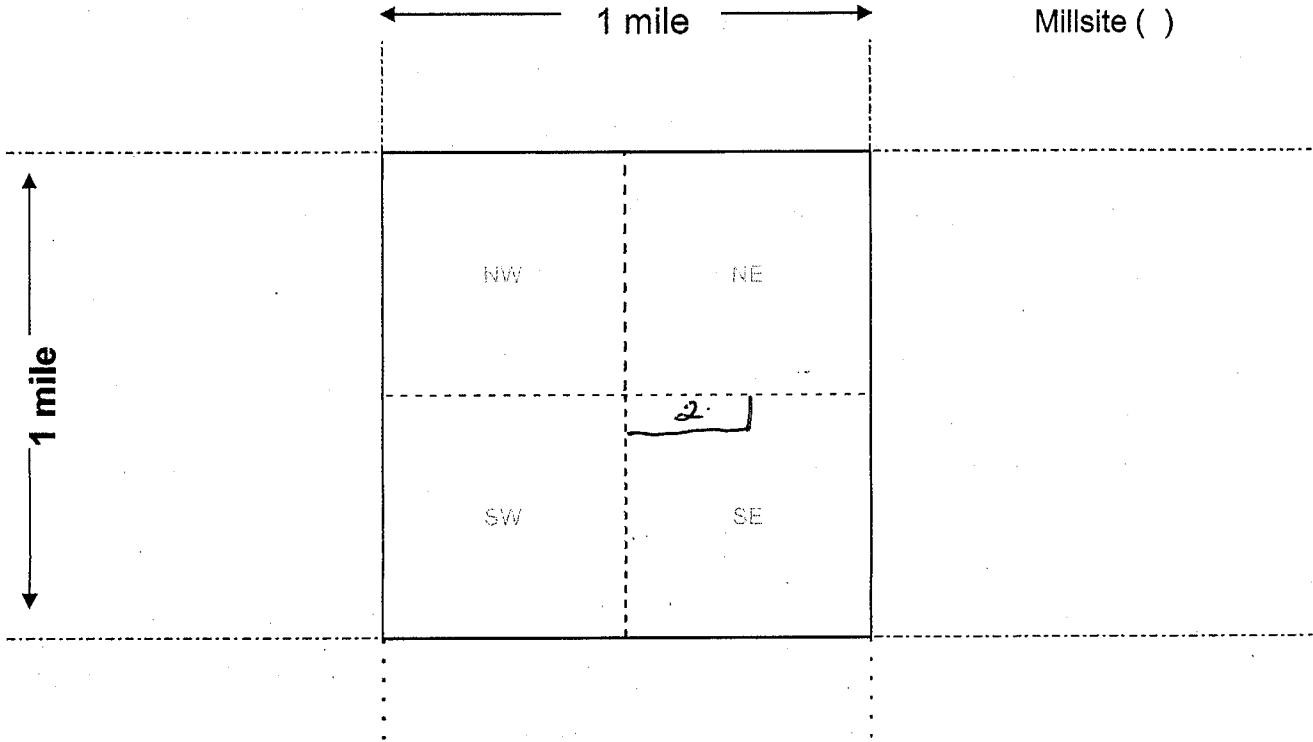

Scale: 1" = 2000 feet



1. The above map depicts the Cobre Grande #2 mining claim, which is located in Section (s) 27, Township 5 S, Range 20 E, Gila and Salt River Base and Meridian,

Aravaipa Graham County, Arizona. Total claim acreage is _____

2. The type of corner and location monuments used are as follows: Stone

3. The bearings and distances in degrees and feet between claim corners and to a public land survey monument are as depicted on the map.

4. If the claim is a placer or millsite claim with exterior limits conforming to legal subdivisions of the public survey, provide a legal description of the claim _____

Form MCF100a
Revised July 2014

LOCATION NOTICE FOR LODE MINING CLAIM

Amendment BLM Serial # _____

NOTICE IS HEREBY GIVEN that the Cobre Grande #3
_____ lode mining claim has been located
by Sharon J. Hinton + Sheena Leon whose current mailing
address is 1311 S. 1st Ave
Safford, Ariz 85546

RECEIVED
BLM AZ STATE OFFICE
2019 MAY 20 P 1:19
PHOENIX, ARIZONA
BLM
Date
Stamp

The general course of this claim is West to East and it is situated in Avavapa Graham
County, Arizona. This claim is 1500 feet in length and 600 feet in width.

_____ Total Claim Acreage. This claim runs from the location monument on which this location notice
is posted on the centerline of the claim approximately 1506 feet in a Westerly direction to the NW
end line and 600 feet in a South direction to the SW end line. This claim is marked by six
monuments, one at each corner and one at the center of each end line of the claim.

The location monument on which this notice is posted is situated within Section 28, Township 5.3
_____, Range 20E, Gila Salt River Base and Meridian, Arizona and this claim encompasses portions
of the following quarter section(s), section(s), Township(s) and Range(s) Quarter Section NE,
Section 28, Township 5S, Range 20E
Gila Salt River Base and Meridian, Arizona.

The locality of this claim with reference to some natural object or permanent monument and additional information
(if any) concerning its locality are as follows: Brass Cap Section 21/22/27/28

_____ The above information is shown on the attached map.

DATED AND POSTED on the ground this 13 day of May, 2019.

LOCATOR(s) AGENT

Print Name(s) Sharon J. Hinton
Signature(s) Sharon J. Hinton

Sheena Leon
Sheena Leon

Form MCF100
Revised July 2014

AMC455001

MINING CLAIM MAP

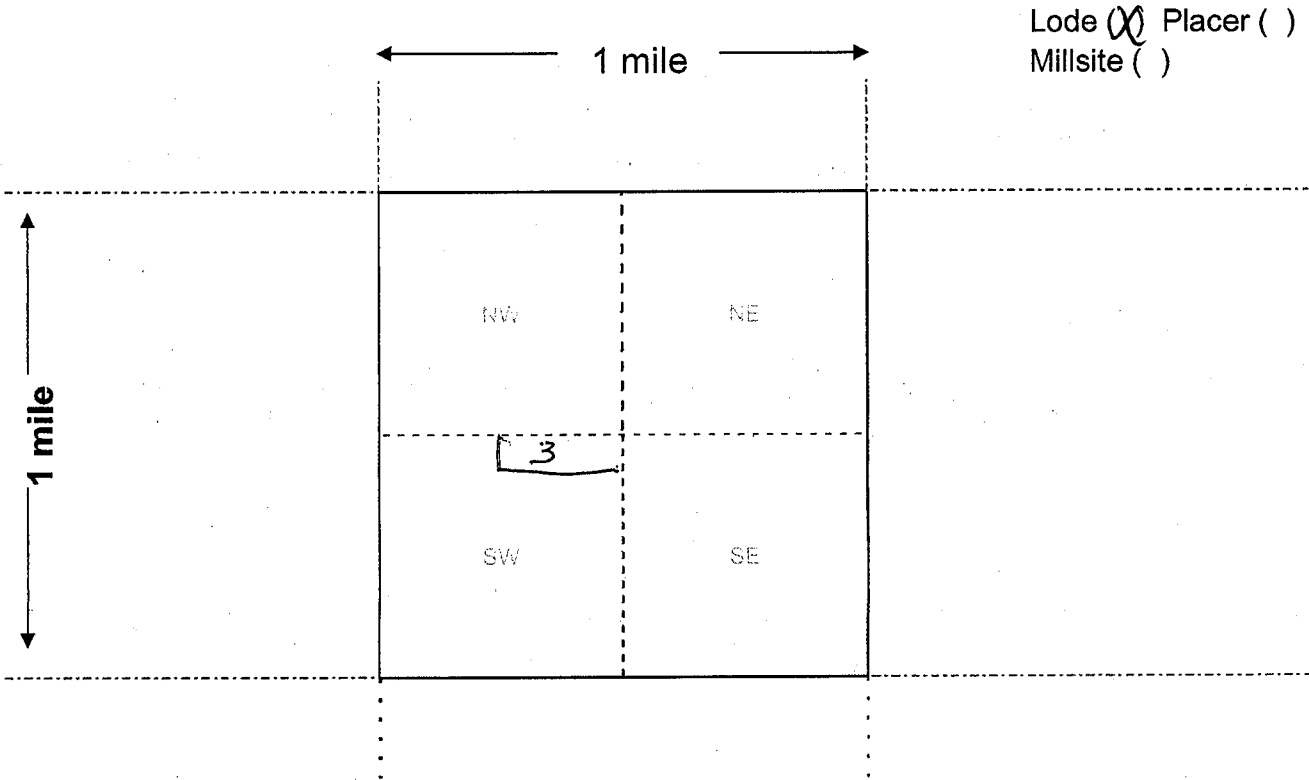

Scale: 1" = 2000 feet



1. The above map depicts the Cobre Grande #3 mining claim, which is located in Section (s) 28, Township S. 5., Range 20 E, Gila and Salt River Base and Meridian,

Avraipa Graham County, Arizona. Total claim acreage is _____

2. The type of corner and location monuments used are as follows: Stone

3. The bearings and distances in degrees and feet between claim corners and to a public land survey monument are as depicted on the map.

4. If the claim is a placer or millsite claim with exterior limits conforming to legal subdivisions of the public survey, provide a legal description of the claim _____

Form MCF100a
 Revised July 2014

LOCATION NOTICE FOR LODE MINING CLAIM

Amendment BLM Serial # _____

NOTICE IS HEREBY GIVEN that the Cobre Grande #4
_____ lode mining claim has been located
by Sharon J. Hinton + Sheena Leon whose current mailing
address is 1311 1st AVE
Safford, ARIZ 85546

RECEIVED
BLM AZ STATE OFFICE
2019 MAY 20 P 1:19
PHOENIX, ARIZONA
BLM
Date
Stamp

The general course of this claim is West To East and it is situated in Aravaipa Graham
County, Arizona. This claim is 1500 feet in length and 600 feet in width.

_____ Total Claim Acreage. This claim runs from the location monument on which this location notice
is posted on the centerline of the claim approximately 1500 feet in a Westerly direction to the NW
end line and 600 feet in a Southerly direction to the SW end line. This claim is marked by six
monuments, one at each corner and one at the center of each end line of the claim.

The location monument on which this notice is posted is situated within Section 28, Township 5S
_____, Range 20E, Gila Salt River Base and Meridian, Arizona and this claim encompasses portions
of the following quarter section(s), section(s), Township(s) and Range(s) Quarter Section NE,
Section 28, Township 5S, Range 20E

Gila Salt River Base and Meridian, Arizona.

The locality of this claim with reference to some natural object or permanent monument and additional information
(if any) concerning its locality are as follows: BRASS CAP SECTION 21/22/27/28

_____ The above information is shown on the attached map.

DATED AND POSTED on the ground this 13 day of May, 2019.

LOCATOR(s) AGENT

Print Name(s) Sharon J. Hinton Sheena Leon
Signature(s) Sharon J. Hinton Sheena Leon

Form MCF100
Revised July 2014

AMC455002

MINING CLAIM MAP

Lode () Placer ()
 Millsite ()

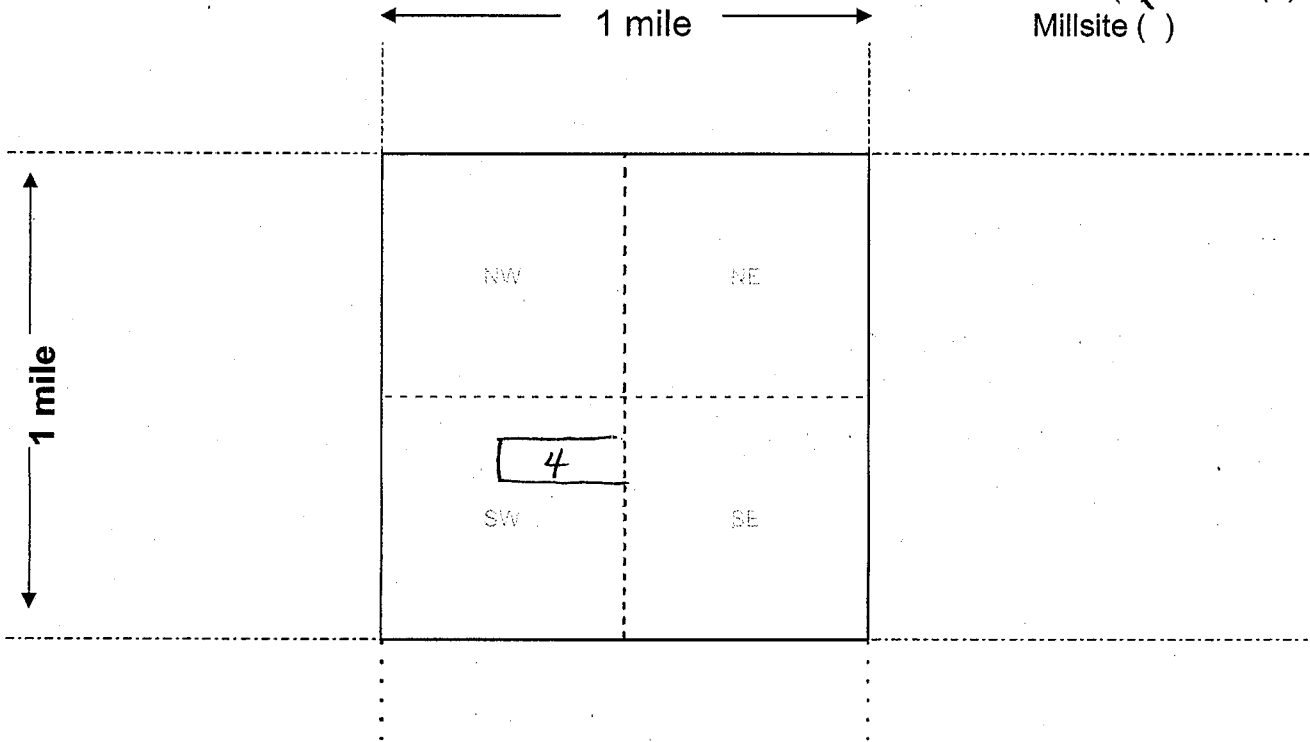

Scale: 1" = 2000 feet



1. The above map depicts the Cobre Grande #4 mining claim, which is located in Section (s) 28, Township 5S, Range 20E, Gila and Salt River Base and Meridian,

Aravapo Graham County, Arizona. Total claim acreage is _____

2. The type of corner and location monuments used are as follows: STONE

3. The bearings and distances in degrees and feet between claim corners and to a public land survey monument are as depicted on the map.

4. If the claim is a placer or millsite claim with exterior limits conforming to legal subdivisions of the public survey, provide a legal description of the claim _____

Form MCF100a
 Revised July 2014

LOCATION NOTICE FOR LODE MINING CLAIM

Amendment BLM Serial # _____

NOTICE IS HEREBY GIVEN that the Cobre Grande HS
_____ lode mining claim has been located
by Sharon J. Hinton + Sheena Leon whose current mailing
address is 1311 S. 1st Ave
Safford, ARIZ 85546

RECEIVED
BLM AZ STATE OFFICE
2019 MAY 20 P 1:19
PHOENIX, ARIZONA
BLM
Date
Stamp

The general course of this claim is Easterly and it is situated in Aravaipa Graham
County, Arizona. This claim is 1500 feet in length and 600 feet in width.

_____ Total Claim Acreage. This claim runs from the location monument on which this location notice
is posted on the centerline of the claim approximately 1500 feet in a Easterly direction to the NE
end line and 600 feet in a Southerly direction to the SF end line. This claim is marked by six
monuments, one at each corner and one at the center of each end line of the claim.

The location monument on which this notice is posted is situated within Section 28, Township 5S
_____, Range 20E, Gila Salt River Base and Meridian, Arizona and this claim encompasses portions
of the following quarter section(s), section(s), Township(s) and Range(s) Quarter NW, section
28, Township 5S, Range 20E
Gila Salt River Base and Meridian, Arizona.

The locality of this claim with reference to some natural object or permanent monument and additional information
(if any) concerning its locality are as follows: Brass Cap Section 20/21/28/29

_____ The above information is shown on the attached map.

DATED AND POSTED on the ground this 13 day of May, 2019

LOCATOR(s) AGENT

Print Name(s) Sharon J. Hinton Sheena Leon
Signature(s) Sharon J. Hinton Sheena Leon

Form MCF100
Revised July 2014

AMC455003

MINING CLAIM MAP

Lode (X) Placer ()
Millsite ()

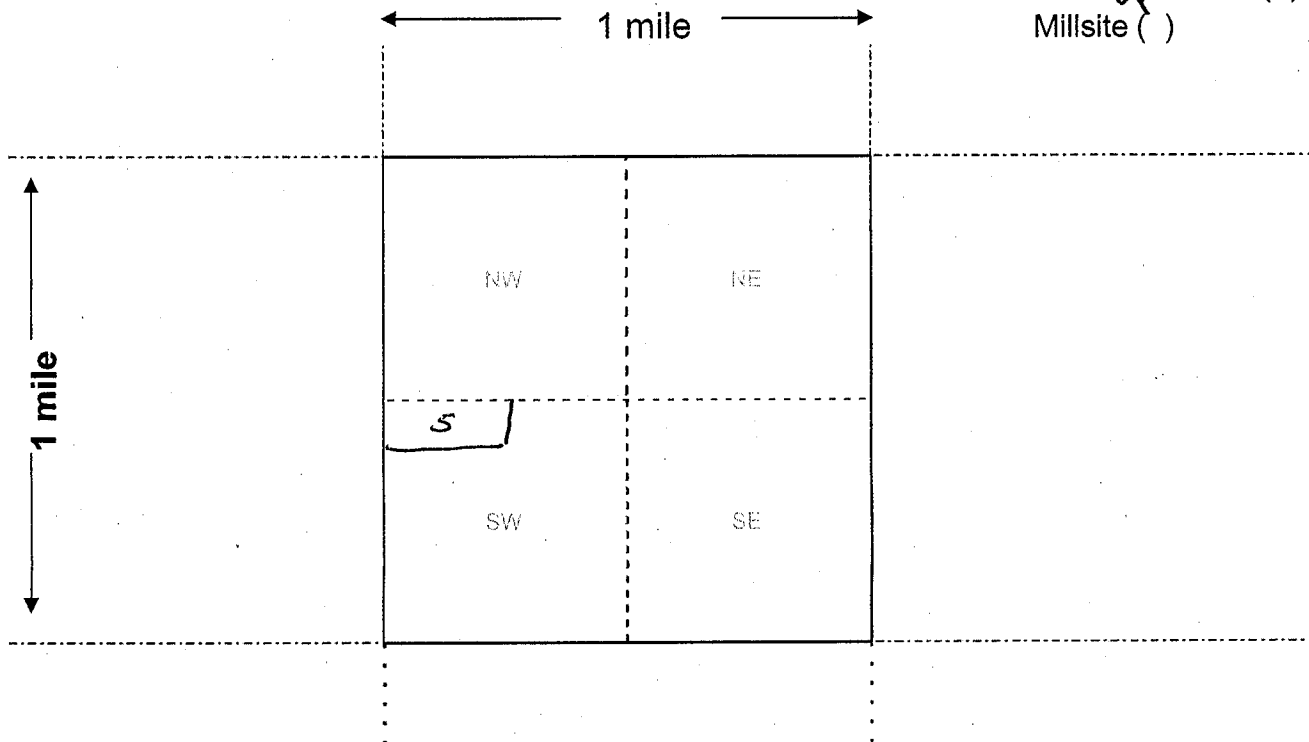

Scale: 1" = 2000 feet



1. The above map depicts the Cobre Grande #5 mining claim, which is located in Section (s) 28, Township 5S, Range 20E, Gila and Salt River Base and Meridian,

Aravaipa Graham County, Arizona. Total claim acreage is _____

2. The type of corner and location monuments used are as follows: stone

3. The bearings and distances in degrees and feet between claim corners and to a public land survey monument are as depicted on the map.

4. If the claim is a placer or millsite claim with exterior limits conforming to legal subdivisions of the public survey, provide a legal description of the claim _____

Form MCF100a
Revised July 2014

LOCATION NOTICE FOR LODE MINING CLAIM

Amendment BLM Serial # _____

NOTICE IS HEREBY GIVEN that the Cobre Grande #6 lode mining claim has been located by Sheron J. Hinton & Sheena L. Leon whose current mailing address is 1311 S. 1st Ave

Safford, Arizona 85506

RECEIVED
BLM AZ STATE OFFICE
2019 MAY 20 P 1:40
PHOENIX, ARIZONA

BLM
Date
Stamp

The general course of this claim is East West to East and it is situated in Aravaipa Graham County, Arizona. This claim is 1500 feet in length and 600 feet in width.

_____ Total Claim Acreage. This claim runs from the location monument on which this location notice is posted on the centerline of the claim approximately 1500 feet in a Eastern direction to the N.E end line and 600 feet in a Southern direction to the SE end line. This claim is marked by six monuments, one at each corner and one at the center of each end line of the claim.

The location monument on which this notice is posted is situated within Section 28, Township S 8, Range 20 E, Gila Salt River Base and Meridian, Arizona and this claim encompasses portions of the following quarter section(s), section(s), Township(s) and Range(s) Quarter Section NW, Section 28, Township S8, 20 E

Gila Salt River Base and Meridian, Arizona.

The locality of this claim with reference to some natural object or permanent monument and additional information (if any) concerning its locality are as follows: USGS Brass Cap section
20/21/28/29

_____ The above information is shown on the attached map.

DATED AND POSTED on the ground this 13 day of May, 2019.

LOCATOR(s) AGENT

Print Name(s) Sheron J. Hinton Sheena L. Leon
Signature(s) Sheron J. Hinton Sheena L. Leon

Form MCF100
Revised July 2014

AMC455004

MINING CLAIM MAP

Lode (X) Placer ()
Millsite ()

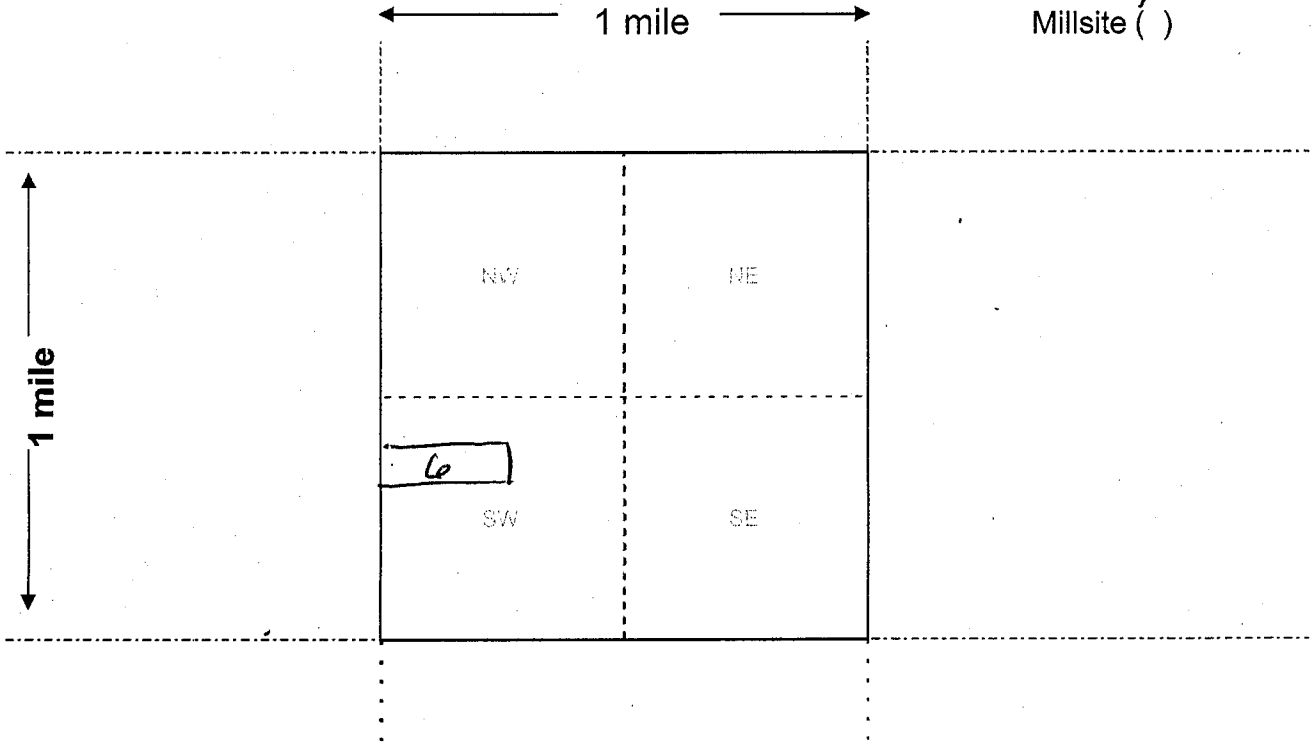

Scale: 1" = 2000 feet



1. The above map depicts the Cobre Grande #6 mining claim, which is located in Section (s) 28, Township S. 8., Range 20 E, Gila and Salt River Base and Meridian, _____ County, Arizona. Total claim acreage is _____

2. The type of corner and location monuments used are as follows: stone

3. The bearings and distances in degrees and feet between claim corners and to a public land survey monument are as depicted on the map.

4. If the claim is a placer or millsite claim with exterior limits conforming to legal subdivisions of the public survey, provide a legal description of the claim _____

Form MCF100a
Revised July 2014



LR2000 Internal

CR Geographic Report with Land

Download User Guide (pdf)

Purpose: This report produces a geographic listing of case information based on retrieval by Meridian/Township/Range. This report format will display the case type, case disposition, meridian, township, range, section, survey type, survey number, surface management agency, pending actions, serial number, and total case acres.

To refresh the query, do a **Ctrl-R**. It resets the page and clears any criteria fields that may have entries.



No Results

The specified criteria didn't result in any data. This is often caused by applying filters and/or selection steps that are too restrictive or that contain incorrect values. Please check your analysis filters and selection steps, and try again. The filters or selection steps currently being applied are shown below.

Filters

Disposition is equal to **AUTHORIZED, CANCELLED, EXPIRED, PENDING, REJECTED, RELINQUISHED, WITHDRAWN**
and Meridian Township Range Section is equal to **14 0050S 0200E 022**
and Admin State is equal to **AZ**

Return - Refresh

DEPARTMENT OF THE INTERIOR
BUREAU OF LAND MANAGEMENT
Case Recordation
Geographic Report with Land

Admin State: AZ
Geo State: AZ
Serial Number: AZA 028551

Total Case Acres: 26,780.000

Casetype	Case Disp	Mer	Twp	Rng	Sec	Sur Type	Sur Nr	Suf	Subdivision	Pending Action
232107	AUTHORIZED	14	0050S	0200E	027	FF			M&B S2SE,SW;	

Date and Time Run:
5/28/2019 1:12:27 PM

Page 1 of 1

DEPARTMENT OF THE INTERIOR
BUREAU OF LAND MANAGEMENT
Case Recordation

Geographic Report with Land

Disposition is equal to **AUTHORIZED , CANCELLED , EXPIRED , PENDING , REJECTED , RELINQUISHED ,
WITHDRAWN**

and Meridian Township Range Section is equal to **14 0050S 0200E 027**

and Admin State is equal to **AZ**

**NO WARRANTY IS MADE BY BLM
FOR USE OF THE DATA FOR
PURPOSES NOT INTENDED BY BLM**

DEPARTMENT OF THE INTERIOR
BUREAU OF LAND MANAGEMENT
Case Recordation
Geographic Report with Land

Admin State: AZ
Geo State: AZ
Serial Number: AZA 028551

Total Case Acres: 26,780.000

Casetype	Case Disp	Mer	Twp	Rng	Sec	Sur Type	Sur Nr	Suf	Subdivision	Pending Action
232107	AUTHORIZED	14	0050S	0200E	028	FF			M&B NESE,S2SE;	

DEPARTMENT OF THE INTERIOR
BUREAU OF LAND MANAGEMENT
Case Recordation

Geographic Report with Land

Disposition is equal to **AUTHORIZED , CANCELLED , EXPIRED , PENDING , REJECTED , RELINQUISHED ,
WITHDRAWN**

and Meridian Township Range Section is equal to **14 0050S 0200E 028**

and Admin State is equal to **AZ**

1311 S. 1st Ave
Safford, Arizona
85546

RECEIVED
BLM AZ STATE OFFICE

2019 MAY 20 P 1:19

PHOENIX, ARIZONA



1000



85004

U.S. POSTAGE PAID
FCM LG ENV
SAFFORD, AZ
85546
MAY 15, 19
AMOUNT
\$1.15
R2304N116868-04

The Bureau of Land Management
Arizona
One north Central Ave
Ste 800
Phoenix, Az 85004 - 4427